

DucoVent Premium Trim

L2005162-B 24.04.2025

APPLICATION

Design vent for both supply and extraction, to be mounted in a plasterboard ceiling (or wall), to be connected to a duct of \varnothing 125 mm.



To be mounted before finishing the ceiling or wall.

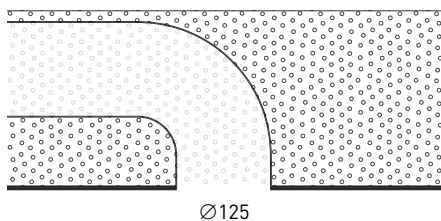

MOUNTING

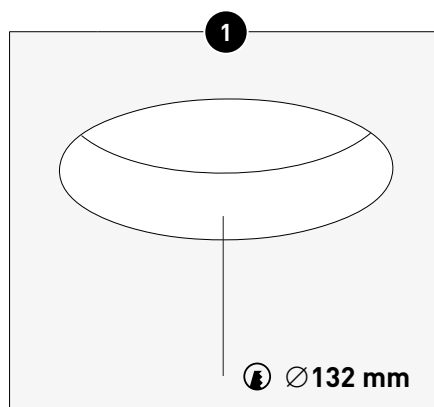

Cut out a hole in the plasterboard at the desired location.
Make sure the surface is flat and even.

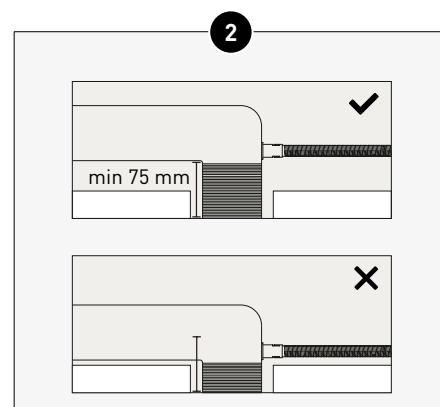

The installation depth must be at least 75 mm to be able to mount the vent.

PARTS

Vent

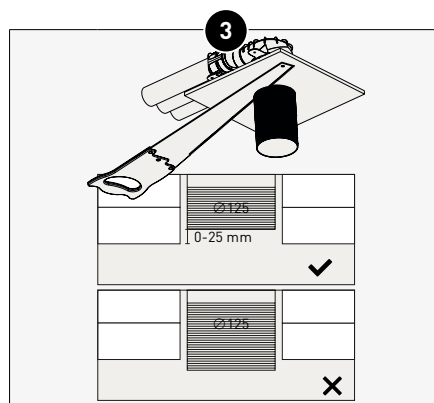
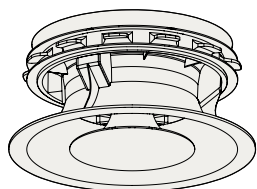

The bottom of the adapter should be at 0 to 25 mm above the finishing layer.
Cut off the extra length.

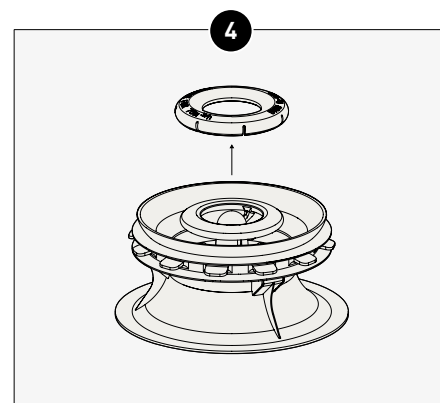

Flow rate up to 50 m³/h:
Leave the 50 m³/h ring in place.
Flow rate between 50 m³/h and 75 m³/h: Remove the 50 m³/h ring.

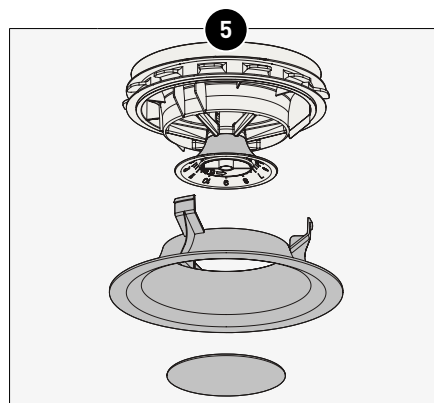

You can paint over the visible parts of the design ring and the vent. Use a synthetic primer for this.

Paintable

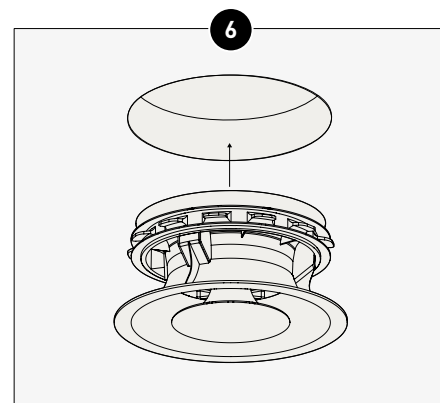

Carefully insert the vent into the opening.

CALIBRATION

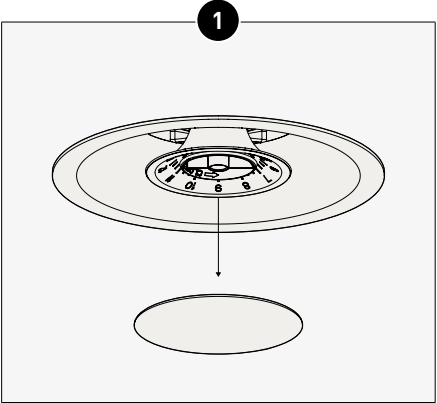

Remove the cover plate.

A top-down view of the unit with the cover plate removed. A circular dial is shown with a yellow highlight on the '12.0' position. An inset shows a close-up of the dial with arrows indicating 'close' (counter-clockwise) and 'open' (clockwise) directions.

Turn the centre piece of the vent to adjust it according to this table:

DucoVent Premium Trim	Position
Position 12.0	100 % open
Position 6.0	50 % open
Position 3.0	25 % open

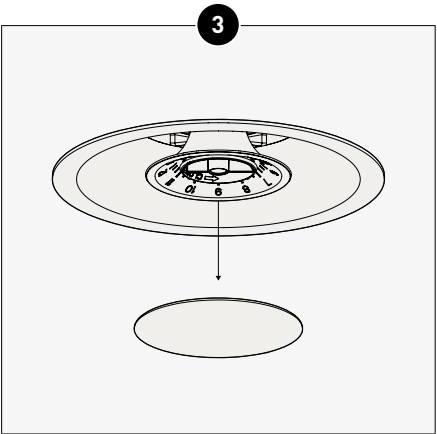

Place the cover plate back.

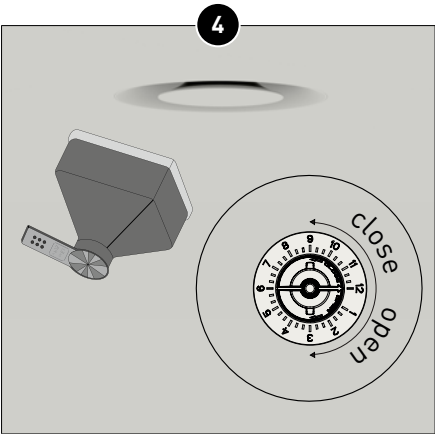

Flow rate control and adjustment.