

**PRODUCT DATA SHEET**

**MW154FRE**

**FIRE RATED EXTRACT VALVE**

**W** RAL9010

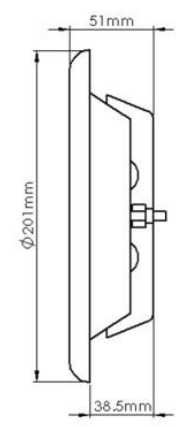
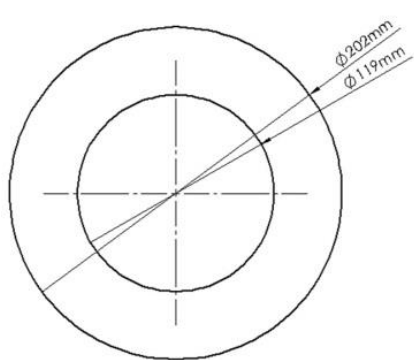

**SPECIFICATION DETAILS**

The MW154FRE 150mm diameter Round Fire Rated Extract Valve is manufactured from White Epoxy Powder Coated Steel. The valve has a male spigot to fit inside the System 150 duct.

The MW154FRE Extract Air Valve is fully adjustable and has a locking nut to fix the position of the control disc upon commissioning. It is supplied complete with a fixing body with pre-drilled holes for installation.

The MW154FRE incorporates an integral intumescent material and has been fire tested to BS EN 1365-2: 1999 with 60 minute rating for ceilings.

MW154FRE has been designed for use with Verplas System 150 Round.

<b>Manufacturer:</b>	Verplas Ltd
<b>Part Number:</b>	MW154FRE
<b>Size:</b>	150mm Diameter
<b>For use with:</b>	Verplas System 150
<b>Box quantity:</b>	7
<b>Individual Weight:</b>	510g
<b>Colour:</b>	White

<b>FIRE RATING</b>	1 Hour
--------------------	--------

**PERFORMANCE CURVE**

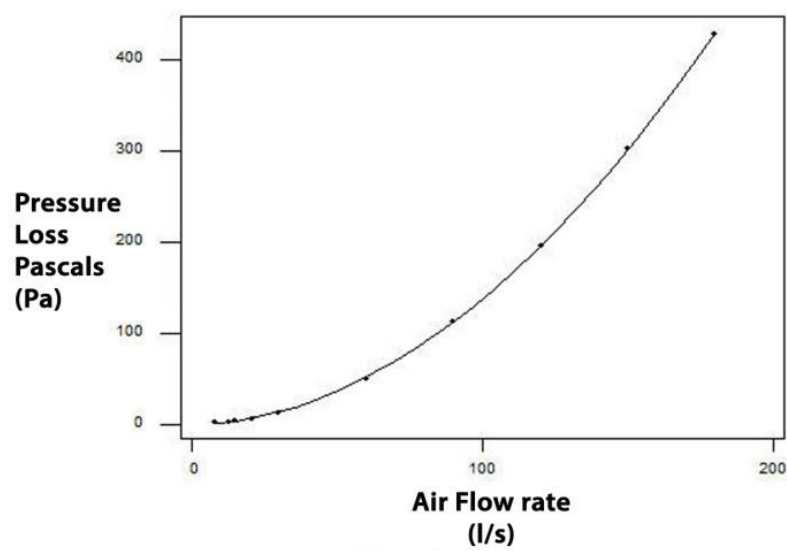

AIRFLOW	RESISTANCE
8 l/s	1.70 pa
13 l/s	2.60 pa
21 l/s	6.00 pa
30 l/s	12.50 pa
60 l/s	49.60 pa
120 l/s	195.20 pa

**Associated Ancillaries**

